



Squeezer Compression Tester



Severe compressive forces occur when packaged-products are stacked during transit or storage. To evaluate the performance of packages, components, and materials under such loads, Lansmont offers a full line of Compression Testers. Lansmont Compression Testers comply with industry standard package testing specifications including ASTM, ISTA, ISO, and MIL-STD.

PERFORMANCE SPECIFICATIONS

Maximum Package Dimensions:

Length 30 in. (76 cm)
Width 30 in. (76 cm)
Height 48 in. (122 cm)

Contact Lansmont for larger configurations.

Verified Force Range:

500 – 5,000 lbs.
(2.22 – 22.2 kN)

Positioning Speeds

Platen positioning speed 27.6 in./min.
(70 cm/min.)

Test speed range 0.1 to 0.51 in./min.
(1.27 cm/min.)

Testing Modes:

Constant rate
Constant load

MADE TO ORDER

Not quite the equipment size or performance level that you need? If we do not already manufacture the test machine ideally suited for your company's testing applications, our engineering team can custom design a test system specific to your needs.

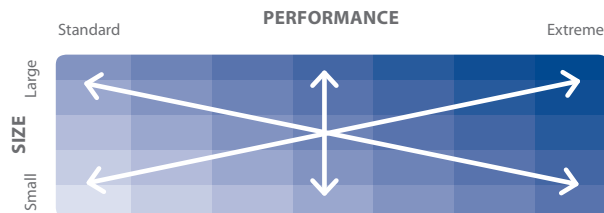

SQUEEZER READER DATA SCREENS

Constant rate test data: Force vs. Deformation

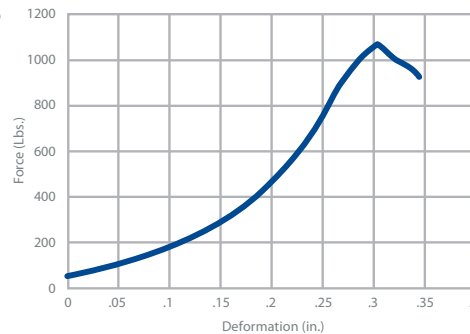

Summary plot: Force vs. Deformation

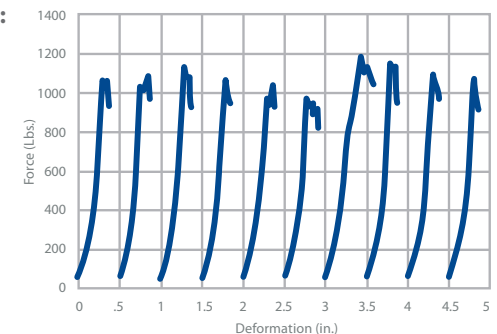



Squeezer Compression Tester



FEATURES



Touchscreen Controller:

The Squeezer uses a digital control system for all machine control and data acquisition. The controls are operated through a touch screen display located on the front panel of the machine. All machine setup, data collection, and data export functions are handled through this backlit, color LCD touch screen.

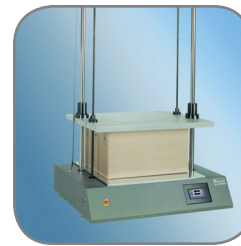

Self-Contained Design:

The self-contained Squeezer design includes a base cabinet that encloses the drive motors, load cell, instrumentation,

and control electronics. Electrical power is the only utility needed. Simply plug the machine into an outlet and begin testing!

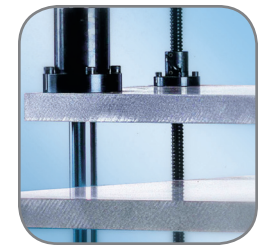

Precise Control:

The smooth, accurate motion of the Squeezer during testing is the result of using precision ball screws to apply compression forces.

Force is measured using a parallelogram-type load cell. Deflection is measured using a precision shaft encoder.

OPTIONS



Fixed/Floating Platen:

The Fixed/Floating platen option gives you increased flexibility in your testing applications. In the floating

orientation, the platen is free to swivel during testing via a "monoball" bearing. In the fixed orientation, adjustable limit stops are used to lock out the lower platen so it is in a fixed orientation during testing.



Oversized Platen:

To accommodate larger box designs, the Squeezer can be built with an Oversized Platen. This increases the maximum package

footprint dimensions to 30 x 44 in. (76 x 112 cm). An Oversized Fixed/Floating platen option is available as well.



Machine Test Stands:

Machine Test Stands provide a stable steel surface to position the machine (standard height is 30 inches (76 cm)).

Test Stands are available in two different widths: 42.5 in. (108cm) or 72.5 in. (184 cm) Large Test Stands also provide a work surface for specimen preparation or staging.



Temperature/Relative Humidity Sensor:

The optional probe mounts to the back of the Squeezer near to where test specimens sit during

testing. The sensor can effectively measure in a 0 – 100°F temperature and 0 – 100% relative humidity range.



Squeezer Compression Tester



SPECIFICATIONS

UTILITIES

Power

Standard voltages: 110 VAC – 1 phase – 60 Hz. (10 amps)
220 VAC – 1 phase – 50 Hz. (5 amps)

Optional voltage: 220 VAC – 1 phase- 60 Hz. (5 amps)

OPERATING ENVIRONMENT

60-80°F (15.6-26.7°C) 20-60% RH

MACHINE DIMENSIONS (standard machine)

Height: 67 in. (170 cm)
Width: 42.5 in. (108 cm)
Depth: 36.6 in. (93 cm)

TEST STAND DIMENSIONS

	Small test stand	Large test stand
Height:	30 in. (76 cm)	Height: 30 in. (76 cm)
Width:	42.5 in.(108 cm)	Width: 72.5 in. (184 cm)
Depth:	25 in. (63.5 cm)	Depth: 25 in. (63.5 cm)

CRATE INFORMATION (standard machine, no test stand)

Height: 83 in. (211 cm)
Width: 55 in. (140 cm)
Depth: 55 in. (140 cm)

WEIGHTS

Gross weight: 1300 lbs. (590 kg)
Net weight: 725 lbs. (329 kg)

SYSTEM DRAWINGS – STANDARD CONFIGURATION

SIDE VIEW

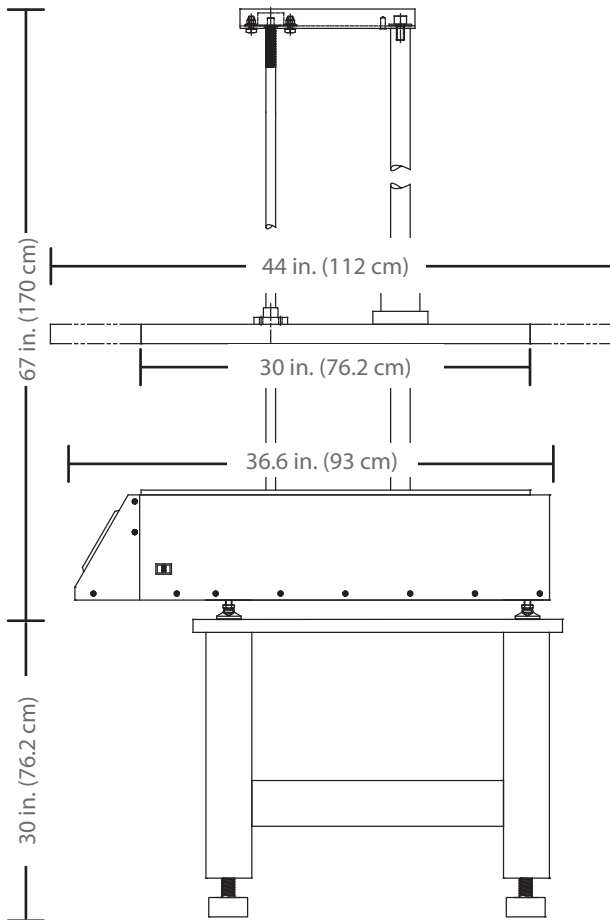

FRONT VIEW

